

VERTICAL ROD

157 051 66 Kit freestanding H200

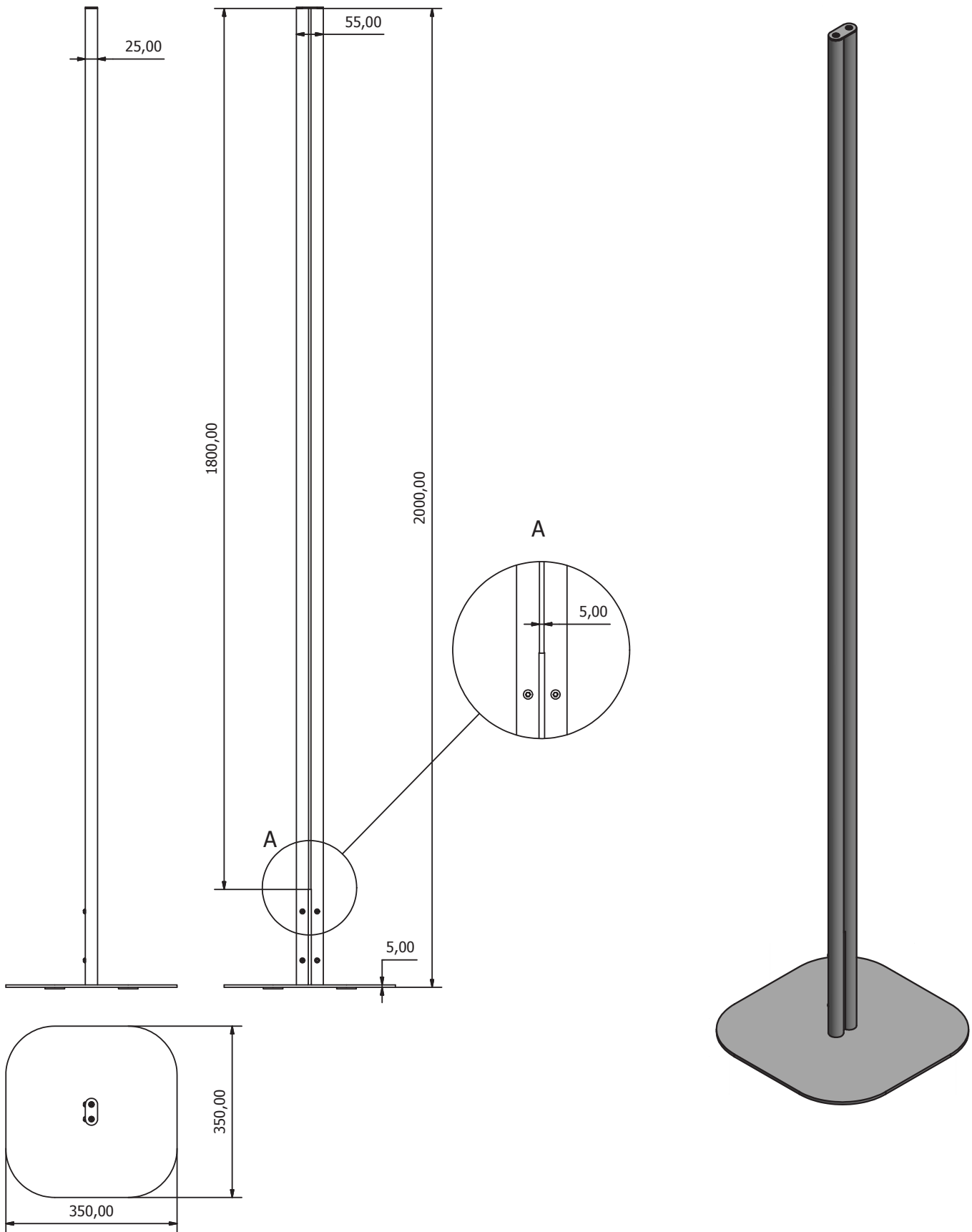

KIT ADAPTER Ø25

157 392 66 **Kit_1** (3 simple terminal adapter)

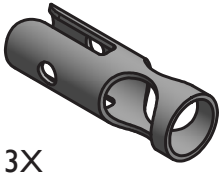

3X

157 393 66 **Kit_2** (3 simple central adapter)

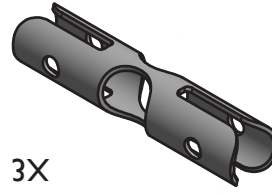

3X

KIT ADAPTER Ø35

157 394 66 **Kit_3** (3 corner terminal adapter)

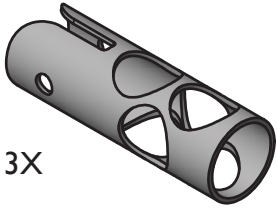

3X

157 395 66 **Kit_4** (3 corner central adapter)

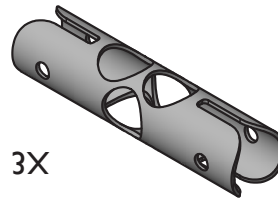

3X

POSSIBLE COMBINATIONS

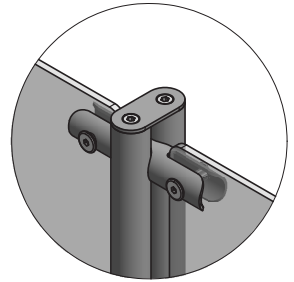
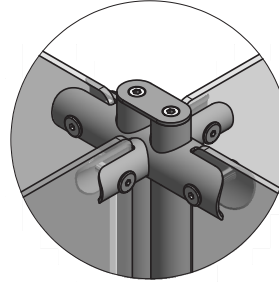
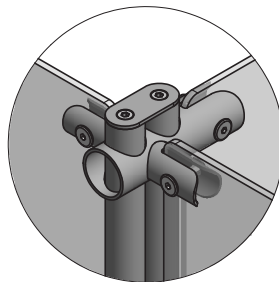
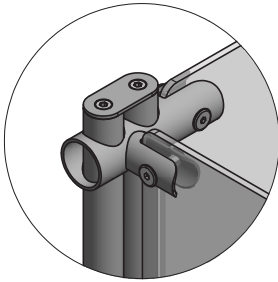
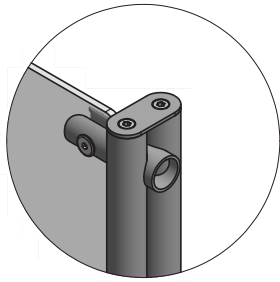

Comb. A Kit_1

Comb. B Kit_1+3

Comb. C Kit_2+3

Comb. D Kit_2+4

Comb. E Kit_2

